

To fit the Front Door Lock you will require -
 a drill, 32mm drill bit, rule, hacksaw, mallet,
 chisel, posidriv screwdriver and pencil

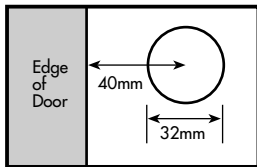

Fig 1

Easy fitting guide

Remove mounting plate from lock body by unscrewing the 2 retaining screws. Select desired height for lock. Mark lock position 40mm from edge of door. Drill a 32mm dia hole through door. **Fig 1**

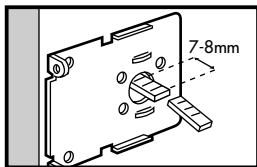

Fig 2

With the key removed, insert cylinder and rose from outside of door. Hold mounting plate against inside door. It may well be necessary to shorten flat connecting bar. **Care must be taken when cutting flat connecting bar to the correct length.** To do so measure between 7-8mm beyond surface of mounting plate, marking flat connecting bar. **Fig 2**

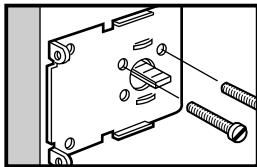

Fig 3

Remove cylinder and using hacksaw, saw off excess bar. Re-insert cylinder and holding mounting plate against door, insert connecting bolts through mounting plate top centre holes into cylinder. Do not overtighten bolts. **Fig 3**

NOTE: For doors less than 45mm thick, connecting bolts need to be shortened using hacksaw.

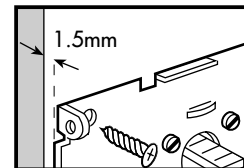

Fig 4

Using wood screws provided, fix mounting plates allowing 1.5mm clearance from edge of door, ensuring mounting plate is parallel with door edge. It may be necessary to loosen connecting bolts to achieve clearance. Ensure bolts are secure after fixing mounting plate. **Fig 4**

NOTE: 2mm dia pilot holes may be necessary in hardwood doors.

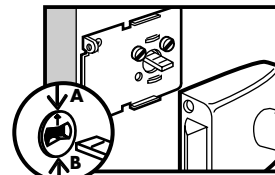

Fig 5

Align arrows on back plate and place lock body onto mounting plate, ensuring the flat connecting bar is inside the lock body slot.

Fig 5

N.B. Hinges on right align arrow with **A**
 Hinges on left insert key and turn 180° align with arrow **B**

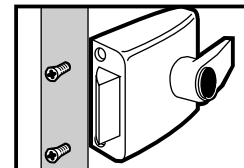

Fig 6

Insert retaining screws to secure lock body to mounting plate. **Fig 6** Check lock operation by following Deadlock procedures below.

How to Deadlock

FROM OUTSIDE: Insert key into lock, turn key 360° anti-clockwise and remove key. The door cannot be opened from outside.

To unlock deadlock - reverse operation. Deadlocking should not be undertaken from outside when persons are inside the house.

FROM INSIDE: Press button in centre of handle.

To release turn handle. Door can also be deadlocked with latch retracted.

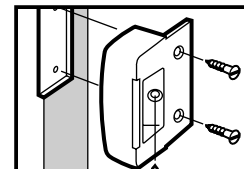

Fig 7

Fitting the Staple

Close door and mark position of staple using lock as guide. Mark area of wood to be removed from door frame and chisel out. Insert 3 woodscrews provided to fix staple, drilling pilot holes if necessary. **Fig 7**

Front Door Lock

60mm Backset Instructions

To fit the Front Door Lock you will require -
 a drill, 32mm drill bit, rule, hacksaw, mallet,
 chisel, posidriv screwdriver and pencil

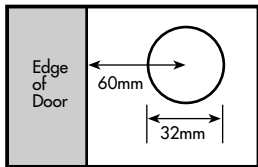

Fig 1

Easy fitting guide

Remove mounting plate from lock body by unscrewing the 2 retaining screws. Select desired height for lock. Mark lock position 60mm from edge of door. Drill a 32mm dia hole through door. **Fig 1**

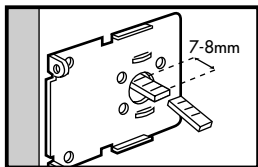

Fig 2

With the key removed, insert cylinder and rose from outside of door. Hold mounting plate against inside door. It may well be necessary to shorten flat connecting bar. **Care must be taken when cutting flat connecting bar to the correct length.** To do so measure between 7-8mm beyond surface of mounting plate, marking flat connecting bar. **Fig 2**

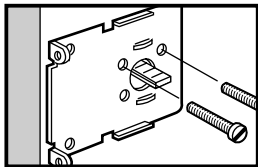

Fig 3

Remove cylinder and using hacksaw, saw off excess bar. Re-insert cylinder and holding mounting plate against door, insert connecting bolts through mounting plate top centre holes into cylinder. Do not overtighten bolts. **Fig 3**

NOTE: For doors less than 45mm thick, connecting bolts need to be shortened using hacksaw.

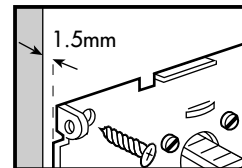

Fig 4

Using wood screws provided, fix mounting plates allowing 1.5mm clearance from edge of door, ensuring mounting plate is parallel with door edge. It may be necessary to loosen connecting bolts to achieve clearance. Ensure bolts are secure after fixing mounting plate. **Fig 4**

NOTE: 2mm dia pilot holes may be necessary in hardwood doors.

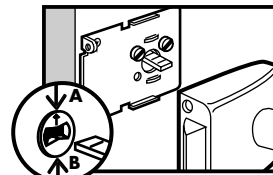

Fig 5

Align arrows on back plate and place lock body onto mounting plate, ensuring the flat connecting bar is inside the lock body slot.

Fig 5

N.B. Hinges on right align arrow with **A**
 Hinges on left insert key and turn 180° align with arrow **B**

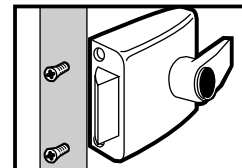

Fig 6

Insert retaining screws to secure lock body to mounting plate. **Fig 6** Check lock operation by following Deadlock procedures below.

How to Deadlock

FROM OUTSIDE: Insert key into lock, turn key 360° anti-clockwise and remove key. The door cannot be opened from outside.

To unlock deadlock - reverse operation. Deadlocking should not be undertaken from outside when persons are inside the house.

FROM INSIDE: Press button in centre of handle.

To release turn handle. Door can also be deadlocked with latch retracted.

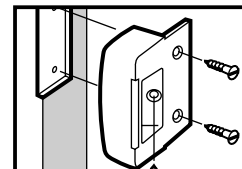

Fig 7

Fitting the Staple

Close door and mark position of staple using lock as guide. Mark area of wood to be removed from door frame and chisel out. Insert 3 woodscrews provided to fix staple, drilling pilot holes if necessary. **Fig 7**