

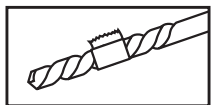

High Security British Standard Nightlatch

Fitting instructions apply to both 40mm and 60mm products.

To fit a High Security British Nightlatch you will require - a drill, 2mm, 6mm, 10mm and 32mm drill bits, rule, hacksaw, mallet, chisel, posidriv screwdriver and pencil.



Before fitting the BS Nightlatch, please make note of the following:

1. For fitting a narrow 40mm backset product - ensure you follow the correct template instructions relating to the 40mm dimensions
2. For fitting a standard 60mm backset product - ensure you follow the correct template instructions relating to the 60mm dimensions

Fitting Tips:

To ensure you drill to the correct depth, mark your drill bits with adhesive tape at the required drill depth prior to drilling.

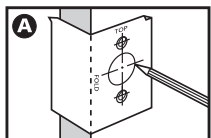

- A** Select desired height for lock. Select either **Mounting Plate Template A** (For doors hinged on the right as seen from the inside) **OR Template B** (For door hinged on the left as seen from the inside). Using the selected template, mark the centres of the 3 holes either 40mm or 60mm (as stated above) from the edge of the door on both sides of the door.

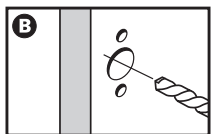

- B** At the middle mark, drilling from both sides of the door, drill a 32mm hole through the door. Working from the **outside** of the door, drill a 10mm diameter hole to a depth of 16mm at each of the two marked spots. Working from the **inside** of the door, drill a 6 mm diameter hole through the door at each of the two marked spots. Countersink these two holes using a 10mm drill bit to a depth of 5mm.

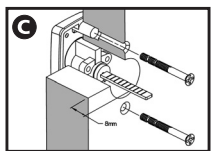

- C** With the key removed, insert the cylinder pull through the door. With a pencil, mark cylinder bar level with inside of surface of door. Remove cylinder and cut bar so that it will project 6-7mm beyond the door face, i.e. beyond the pencil mark. Re-insert cylinder and secure with (x2) large screws provided ensuring they are sunk below the door surface. Do not over tighten bolts.

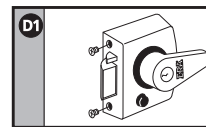

- D** Remove mounting plate from lock body by unscrewing the 2 retaining screws. Use D2 when hinged on the right (viewed on the inside). Rotate plate 180° when hinged on the left (veiwed on the inside). Place the mounting plate over the connecting bar. Secure the mounting plate to the cylinder pull using the two slotted connecting bolts through the mounting plate top centre holes. Do not over tighten the bolts.

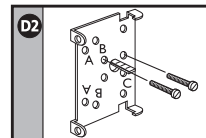

Note: For doors less than 45mm thick, connecting bolts may need to be shortened using a hacksaw. Using the 4 wood screws provided, secure the mounting plate in positions A and C. When fixing mount plate, if holes A are not suitable due to previous holes etc, fix plate using positions B.

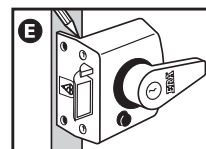

- E** Using lock as template, locate lock body over mounting plate. Mark area to be removed from the door edge remove lock from mounting plate and chisel out so that the lock face (kitemarked edge) sits flush. Mark the position of the 2 fixings holes. Remove lock and drill positions marked, drilling pilot holes if necessary.

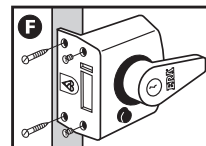

- F** Locate lock body over mounting plate and slide lock to engage locking pegs, ensuring lock face (kitemarked edge) fits flush in recess. Replace the 2 retaining screws and secure lock using the 2 wood screws provided.

G Fitting the staple

Close door and mark position of staple using lock as guide. Mark area of wood to be removed from door frame and chisel out so that the staple fits flush with door frame. Fix staple with screws provided, drilling pilot holes if necessary.

Operation

Insert key from outside and turn to open door.

Deadlocking

BS3621 range only (Not applicable for BS8621 range)

From inside, insert key into handle and turn 360° and remove key. The door cannot be opened from the inside. To unlock-reverse operation.

Maintenance

Use a moist cloth only to clean all types of finish. Household abrasives or solvents may affect the surface finish.

Guarantee

The Guarantee covers defective workmanship should the lock become inoperable within 10 years. Any repaired or replaced goods shall be delivered by the company free of charge to the original point of delivery. Proof of purchase (receipt) must be produced.

The Guarantee does not cover:

1. Misuse, none authorised repairs, or incorrect maintenance.
2. Tarnishing or discolouration of product as this is affected by environmental conditions
3. Incorrect fitting.



Reduce the risk with ERA PRODUCTS LTD

TECHNICAL HELPLINE
01922 490 050

Call 01922 490000 for your FREE brochure
www.erasecurity.com